

ALL DIMENSIONS TO BE CHECKED ON SITE

N. ANDREW WILDING
Architect, Design & Planning Consultant
CITY DESIGNS
3, Wasps Nest, Nocton Fen,
Lincoln, Lincs. LN4 2AZ
Tel/Fax: 01526 322281

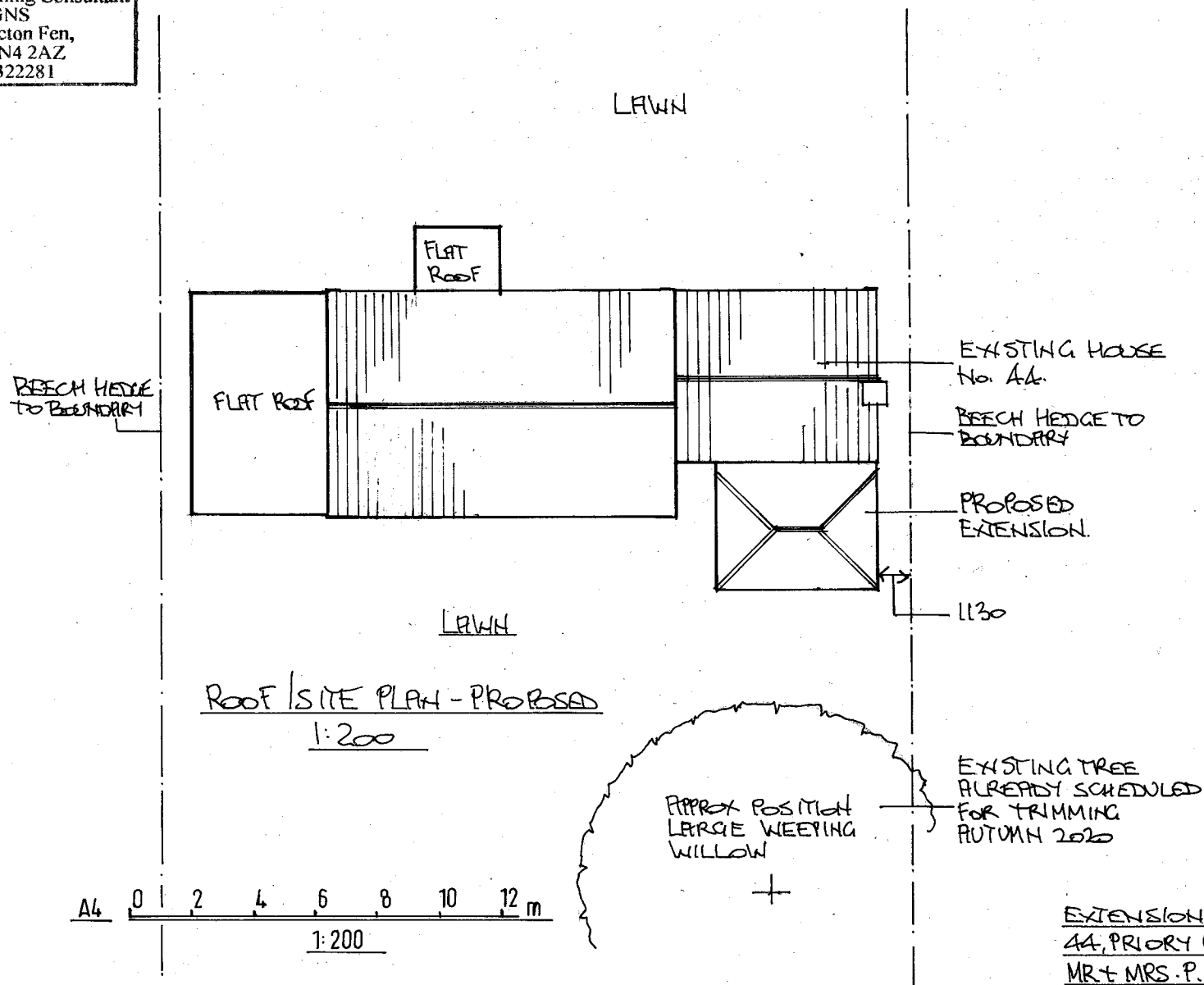

EXTENSION TO EXIST. DET. HOUSE
44, PRIORY ROAD, FISHTOFT, BOSTON.

MRS & MRS. P. CHAPMAN

SCHEME DRG. No. 5 1:200

DATE 21/7/2020

DRG. REF. 2020.23.5.